

How to Use

Trusted. Simple. Effective.



**Professional
Cleaning System**

with **SPEED CLEANING
POWER**

FILLING SPRAYS

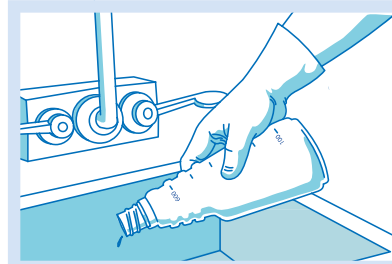

1. Always empty the spray bottle before refilling!

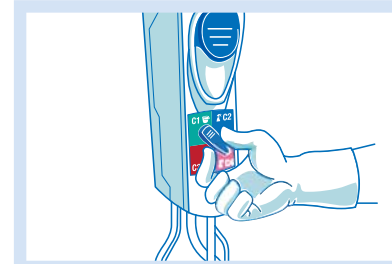

2. Select the right dose (For selector unit only).

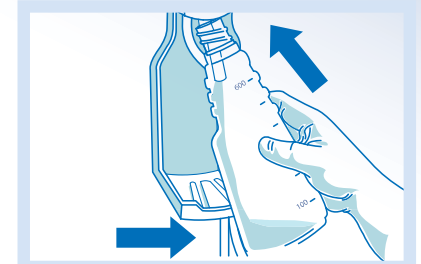

3. Push bottle up to fill. Keep the spray bottle tilted while filling.

FILLING BUCKETS OR AUTOSCRUBBERS

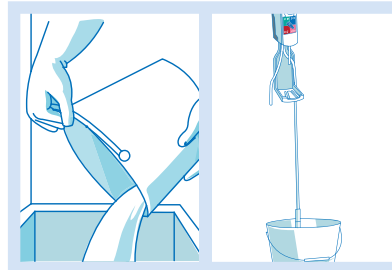

1. Place hose into the empty bucket.

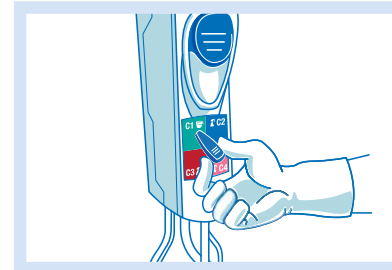

2. Select the right dose (For selector unit only).

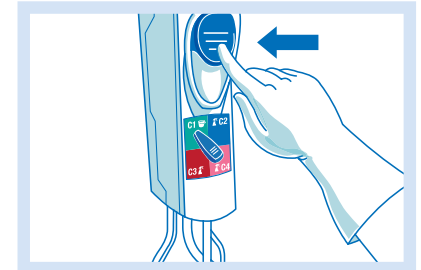

3. Push the button until the bucket is filled.

ACTIVATE A NEW CANISTER

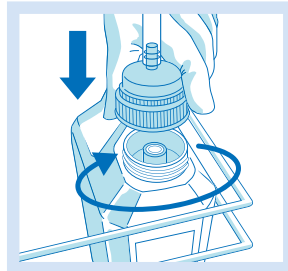

1. Remove canister cap. Then connect tube with its cap to the canister.

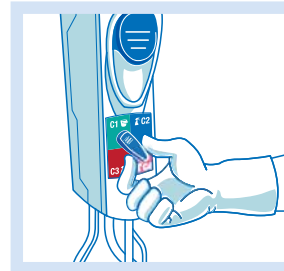

2. Select the right dose (For selector unit only).

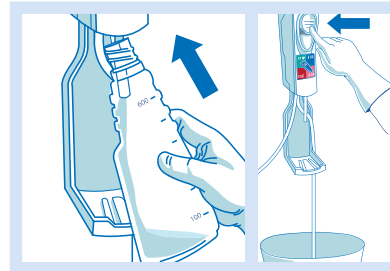

3. Activate the pump until the tube is completely filled.

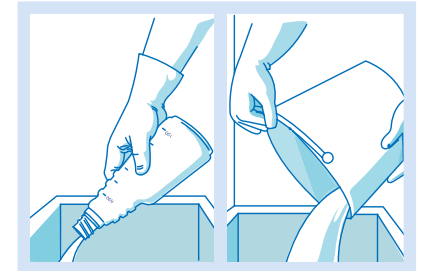

4. Empty the spray bottle or canister.

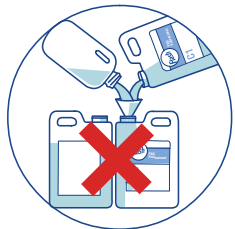

Never mix products or add water to canisters. Always wear the protective equipment specified by your employer.



every experience counts.™

**P&G
Professional**